

REPORTER

User manual

English



4k 15fps / 1080p 60fps
720p 120fps



Wifi Function



Wide angle



Touchscreen



Photo
resolution: 14m

CONTENTS

1.ATTENTION / WARNING / WAARSCHUWING	3
2.Battery	4
3.Precautio n of use	6
4.Warning	7
5.Download the App	8
6.Included in the pack	9
7.Camera parts name	10
8.Specifications	13
9.Remote control	14
Remplace the remote control's battery	14
Remote controller	15
Connect the remote control to the camera	15
Remote control utilization	15
10.Camera configuration	16
Charging the battery.	16
Waterproof camera	16
Inserting the memory card	17

11.Camera operation	18
Turn on/ off the camera.....	18
General configuration	18
Effects configuration	20
Changing the modes of the camera	21
Record videos	21
Video settings	21
Take photos	23
Photo settings	23
Playback.....	24
Using the external microphone (Optional)	24
Transferring camera's files on a PC.....	24
Connecting the camera to a HD TV	24
How to use the App on a smartphone	25
12.Maintenance	28
13.Warranty	29
14.Recycling	30
15.Declaration of conformity.....	31
16.Trademarks	32
17.Modifications	32

1.ATTENTION / WARNING / WAARSCHUWING

FR

Veillez lire le "Manuel d'utilisation" entièrement et attentivement avant toute utilisation Le manuel mis à jour est disponible sur le site www.pnj.fr/modes-demploi/

ATTENTION: Toutes les précautions d'utilisation concernant les batteries doivent être suivies rigoureusement. Une mauvaise manipulation de la batterie peut provoquer un incendie, une explosion, des blessures personnelles ou des dégâts matériels.

EN

Please read the operation manual carefully before using the product The english User Manual can be downloaded on our website: www.pnj.fr/en/user-manuals/

WARNING : Batteries are dangerous, please follow the instructions to avoid injuries or damages

NL

Lees de instructies in de bedieningshandleiding zorgvuldig door voordat u onze producten gebruikt

De bedieningshandleiding kunt u downloaden vanaf onze website: www.pnj.fr/en/user-manuals/

WAARSCHUWING : Bateria's zijn gevaarlijk, het niet opvolgen van de gebruikshandleiding kan blessures en schade veroorzaken.

2.BATTERY

- By owning, charging or using the Li-battery, you assume all risks associated with the use of lithium batteries.
- Always keep out of reach of children.
- Never leave the battery unattended while charging.
- Never leave the battery charged for more than 1 hour.
- Use only the USB charger provided in the pack. Never use a non-adaptable charger.
- Before charging the battery, check that it is not damaged. Check that the battery has not swollen or that the battery compartment is not punctured. If you notice any of these situations: **DO NOT CHARGE THE BATTERY!**
- A used battery must be removed from the unit and replaced.
- If you notice that the battery starts to swell during charging, disconnect the battery immediately and do not use it again. Continued use of an inflated or deteriorated battery may cause an explosion.
- Make sure that the output voltage of the charger matches the battery voltage. Do not charge at a higher current than recommended. Use only the charger provided in the pack.
- Disconnect the battery from the charger if it becomes too hot (Never exceed 49 ° C / 120 ° F) or swells. If the battery becomes hot, disconnect the charger immediately.
- Charge only on non-flammable surfaces. Never charge inside a vehicle!
- Do not expose the battery to any source of heat or high temperature.
- Never put the battery in contact with water or immerse it in any other liquid.

- Improper use of the battery may cause fire, explosion or other hazards.
- In case of fire caused by the battery, do not use water to extinguish the fire (sand is recommended).
- Do not carry unwrapped batteries in your pocket or bag, as the shock of the batteries against each other could cause a short circuit.
- Store the battery in a dry place at room temperature.

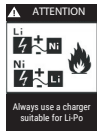

3. PRECAUTION OF USE

When using your drone, be sure to observe the following precautions:

- Not suitable for persons under 3 years of age.
- Caution: risk of ingestion of small parts.
- Be sure to use this product in a safe and responsible manner to avoid personal injury and / or property damage.
- Make sure that your use is in accordance with the legal provisions of the country where you are located.
- Avoid contact with sand, dust, water, liquid substances or heat, it could cause irreversible damage.
- Not suitable for people with epilepsy.
- Observe the safety instructions in this manual.
- Use only the accessories supplied by PNJ.
- Before each utilization, check that the batteries are fully charged.

4.WARNING

The law required to use this action cam in prudent and responsible manners to avoid all human or material damage. In case for unauthorized use or for illicit purposes, you will be fully responsible for any damage causes. Be sure to respect laws, without violating the privacy of other people. PNJ assumes no responsibility in case of damage resulting directly or indirectly from the use of this device, any parts of this device or the manual. PNJ is not responsible for any accident, injury, death, loss or other claim of any kind related or resulting the use of this product.

5.DOWNLOAD THE APP

Scan the QR code below, to have the access to our website www.pnj.fr and download the application for free. You can also search "Reporter App" in Google Play Store or Apple Store to download the application for being able to control the action cam in distance via your smartphone.



6. INCLUDED IN THE PACK



Waterproof case



Protective cover



Clip



Remote control



Helmet Mount



Quick release mount



Lock bolt



Spanner



USB Cable

7. CAMERA PARTS NAME

1. Power/Navigation

2. Mode/Shutter

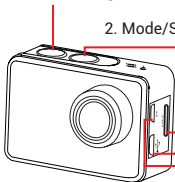

3. Micro SD card Slot

4. Mini USB Port

5. HD Port

6. Internal Mic

7. LCD Touch Screen

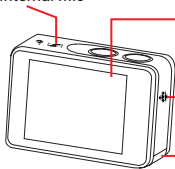

8. Speaker

9. Li-ion Battery Power

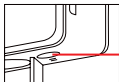

10. 1/4" screw hole

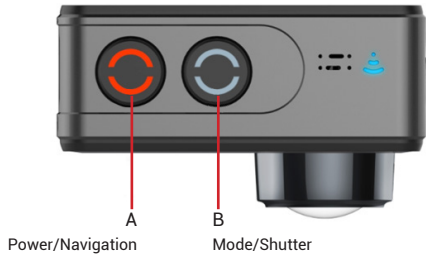



8.SPECIFICATIONS

Video resolution	4K 15fps / 2.5K 30fps / 1080P 60fps / 720P 120fps
Photo resolution	14M
LCD screen	Touchscreen 2"TFT
Battery	Lithium-ion battery 1100mAh
WI-FI	Wifi connection up to20m
Custom application	Android & iOS
Remote controller	Wireless remote control 2.4 G RF
SD card	Up to 32GB

Charging	Fast
Waterproof case	Up to 30m under water

9.REMOTE CONTROL

- **Replace the remote control's battery**

When the battery in the remote is close to being fully discharged the red LED indicator will flicker once per second indicating that you need to replace the button battery.

1. Please purchase a replacement button battery with model No. CR2032.
2. Unscrew the round cap at the bottom of the remote, see the pictures for reference.
3. Remove the old battery.
4. Insert the new battery into the slot where the old battery was, with the flat surface up.
5. Screw on the round cap at the bottom of the remote.

- **Remote controller**

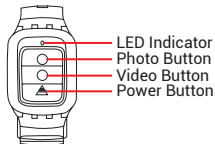

- **Connect the remote control to the camera**

- Press any key of the remote, the camera and the remote will begin the pairing process automatically, the LED indicator will blink blue before being successfully paired. After pairing, the Reporter action camera will show: "Bluetooth Pair Succeed" and the LED indicator of the remote will light blue.

- **Remote control utilization**

Photo Shooting: Press the Photo button once to shoot a single picture, the LED indicator of the remote flickers twice.

Video Recording: Press the Video button once to start recording, the LED indicator will flicker twice, press the video button again to stop recording.

Powering Off: Press the Power Off button and hold it for 3 seconds to turn off the camera, the LED indicator turns off accordingly..

10. CAMERA CONFIGURATION

- **Charging the battery**

-Before using the Reporter for the first time, please fully charge the battery

1. Connect the Reporter with a charger or device by Micro USB cable .

2. Charging Indicator A turns red during charging.

3. A complete flat battery takes around 2.0 hours to get fully charged. The red indicator turns off after the battery fully charged.

4. When the battery is going to run flat, the red indicator A blinks twice a second.

5. Some functions such as Wi-Fi is unavailable if the battery in low condition.

Note : The camera may heat up after being used for a while.

- **Waterproof camera**

- The Reporter can be use under water with it waterproof case. Please close it carefully to avoid any damage on the camera. Clean the case before each use, make sure there are no sand, dust, hair or other elements. You can now use your camera up to 30 meters under water.

- **Inserting the memory card**

- This camera is not equipped with an intern SD card. For a normal operation, prepare a TF or SD card (class 6 at least), then follow the instructions below for correctly insering a SD card into the camera.

1. Turn off the camera

2. Open the cover on the side of the camera then find the right slot. You will heard a "click" if the card has been inserted successfully.

Notes	<ol style="list-style-type: none">1. We suggest using Class 6 (or higher) Micro SD card for Smooth shooting. Lower Class Micro SD Cards may cause the video to blur or not record at all.2. There is only one correct direction to insert the SD Card into the slot. Do not force the card into the card slot as it may damage both the SD Card and camera.3. A new Micro SD Card should be formatted before using.4. The Reporter can be mounted using the accessories provided.
-------	--

11. CAMERA OPERATION

- **Turn On/ Off the camera**
 1. Long press the Power button (A) for 3 seconds to power is on, indicator C turns blue.
 2. Long press the Power button (A) for 3 seconds to power off, indicator C blinks and then turn off.

- **General configuration**

CONTROL	This allows user to set the microphone volume, Speaker volume, LCD Brightness.
BEEP	Turns the sound when a button is pressed on or off.
LED INDICATOR	Turns the LCD indicator on or off.
BLUETOOTH	Turns Bluetooth on or off.
QUICK RECORDING	The camera will start recording (depending on your choice: video or photo) after a few seconds when the camera is turned on.

SCREENSAVER	This will determine if the LCD will turn off after 1 min, 3 min or 5 min. Press any key to turn the screen on. Select OFF to keep the screen always ON.
AUTO POWER OFF	The camera turns off when not in use after specified time..
TV OUT	Setting the desired TV standard, PAL or NTSC.
TIME SETUP	Adjust the date &time.
LANGUAGE	Change the device language, total of 4 different languages.
MEMORY FORMAT	Format the inserted SD card. Choosing to format the card will permanently erase all data on the card.
DEFAULT	Resets the camera to factory settings.
Wi-Fi	Turn the Wi-Fi function on or off.
Wi-Fi INFOS	Display the current WiFi SSID & Password.

Note: You can easily access some settings such as Beep, Mic, Speaker, Invert and Wi-Fi with touch operation by swiping up.

- Press the power/ navigation button, to start the recording.
- The duration of the recording will be show on the LCD screen.
- If a low speed SD card is being use, the video will be adjust in 720p automatically.

- **Effects configuration**

ZOOM	To zoom the image x1, x2, x3, x4.
FILTER	To define the amount of color saturation..
AE METER	To define which image areas are used to calculate the correct exposure.
WHITE BALANCE	Factory default is Auto. If you switch Auto OFF, remember to adjust when lighting conditions change.
ISO	This is the measurement of the sensor's sensitivity to light.
UPSIDE DOWN	To rotate the screen.
TIME STAMP	To define if the time mark is displayed at the bottom of the videos or pictures.

- **Changing the modes of the camera**

1. Mode changing (A)

- When the camera is turn On, press on the button (A) to go in the differents modes: Video, Photo, Playback, Settings. Stop pressing the button (A) to select the desired mode.

-It is also possible to access thoses modes via the touchscreen by swiping on the left.

2. Mode changing (B)

- When the camera is turn On, long press on the button (B) to enter in the settings: Video - Photo - Effect - General

- **Record videos**

- Press the Shutter button (B) when powered on, LED D turns green and keep blinking twice a second; Press again to stop, and LED D light will turn off.

- **Video settings**

- Press the Power Button (A) once to navigate, press the Shutter Button (B) to Enter/Confirm selection

MODE	To set the video mode, Manual, Looping, Auto Stop, Timelapse.
RESOLUTION	4K 15fps / 2.5K 30fps / 1080P 60fps / 720P 120fps
FOV	To set the lens wide angle, Super Wide, Wide, Medium, Narrow.
VIDEO QUALITY	To set the video quality.
DIS	To set the digital image stabilization.
SCENE MODE	To set different scene mode, Manual, Water, Riding, Winter, Diving, Night.

You can easily access this mode with touch operation by swiping right.

- **Take photos**

Press the Shutter button (B) once to shoot a single picture, LED D flashes green.

- **Photo settings**

Press Power Button (A) once to navigate, press Shutter Button (B) to Enter/Confirm selection.

MODE	To set the photo mode, Manual, Timelapse, Burst, Self Timer.
MEGA PIXEL	14M / 12M / 8M / 5M
FOV	To set the lens wide angle, Super Wide, Wide, Medium, Narrow.
PHOTO QUALITY	To set the picture quality.
SCENE MODE	To set different scene mode, Manual, Outdoor, Indoor, Portrait, Landscape, Night.

- You can easily access this mode with touch operation by swiping right.

- **Playback**

- Press the Power button (A) to navigate.
- Long press the Shutter button (B) to enter the selection.
- Short press Shutter button (B) to play.
- Short press Shutter button (B) again to exit the play control panel.

You can operate the Reporter Action camera more easily by tapping the screen.

- **Using the external microphone (Optional)**

- Insert the external MIC to Mini USB port, the camera will automatically switch to record the sound from the external MIC. This will help to reduce noise and get better video sound.

- **Transferring camera's files on a PC**

- There are 2 ways to transfer the files from the camera to a PC :
 1. You can remove the Micro SD card from the camera and use a card reader (not included)
 2. You can use the included USB cable to connect the camera to your computer.

- **Connecting the camera to a HD TV**

- You can display the camera LCD screen on a TV screen.

Note: You will need an extra Mini HDMI to HDMI cable, which is not included in the standard package.

1. Turn the camera on.
2. Connect your mini HDMI to HDMI cable with the Reporter action camera and your TV.
3. Select the right source on the TV.

- **How to use the App on a smartphone**

- The Reporter allows full camera control, live previewing and playback of photos/videos on most Smart phones and Tablets.

1. Download the App "Reporter App" from the "Google Play" or from the Apple "App Store".
2. Activate Wi-Fi in the GENERAL SETUP MENU.

Note: You can easily access the Wi-Fi setting with touch operation by swiping up

3. Go to the Wi-Fi settings on your Phone, you will see Reporter_xxxxxxx in the list of available Wireless networks.

Note: You can change the Wi-Fi name in the menu setting.

4. Connect your Phone to the "Reporter_xxxxxxx" via Wi-Fi. The default Wi-Fi Password for the Reporter is: 1234567890.

Note: You can change the Wi-Fi password in the menu setting.

5. Open the app "Reporter App"

Important: Before connecting the camera via Wi-Fi, you need to download the "Reporter App" on your smart phone or tablet.

Open the app

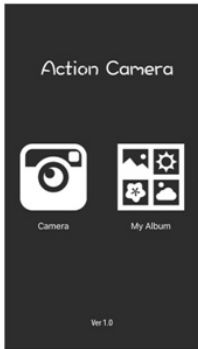

Connect successfully

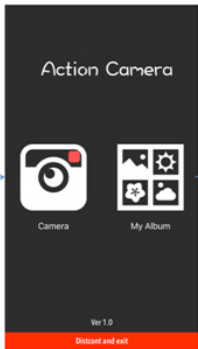

Enter the live interface



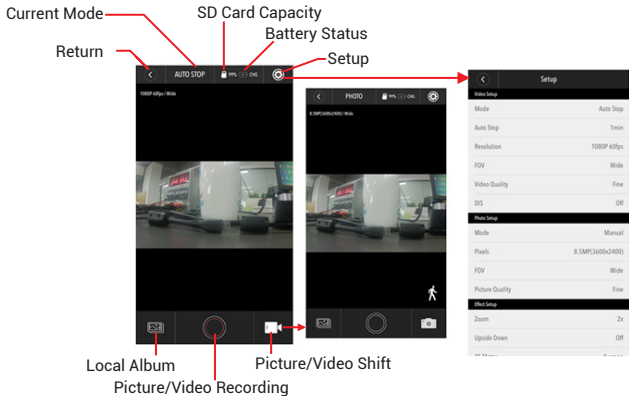

12.MAINTENANCE

- The battery should be stored in a dry and ventilated area. The storage temperature range is between 18°C and 25°. Avoid to charge and uncharged excessively to extend its life. Ensure to charge it before storing it, if it won't be use for a long period.
- If the action cam won't be use for a long period, be sure to remove the batteries from the compartment. Battery leakage may damage the action cam and may cause a fire. Once used, ensure to throw the batteries according the legal regulations in order to preserve the environment.
- To avoid any problems, we strongly advise you to have the habit to remove the action cam's battery when you are not using it.
- Make sure to store your materials in a dry place, away from water and the heat.
- The maintenance can only be carried out by the After-sell Service from the shop or from the distributor. If you find a problem with your action cam, be sure to call them directly. It's not recommended to change by yourself the lens for example, because its requires technical knowledge.
- Use only the accessories specified by the manufacturer.
- Find out all our products and accessories in our website www.pnj.fr

13.WARRANTY

This product is warranted for a period of 24 months from the date of original purchase by the consumer, except for certain wear parts, against manufacturing defects, upon presentation of proof of purchase (receipt with date, place of purchase, name of the product).

During the contractual warranty period, the defective product must be returned in its original packaging to the retailer's service center or to the www.pnj.fr website, depending on the place of purchase. After inspection of the product, the after-sales service will repair or replace the defective part or product, to the exclusion of any other compensation, if the product has been used correctly.

The warranty does not cover:

- All damaged or deteriorated as a result of a fall or accident, voluntary or involuntary.
- The battery charger when connected to a wall power supply (voltage too high).
- Products that have undergone unauthorized alterations, modifications, customizations or other assembly.
- Damage resulting from accidents, normal wear and tear, contact with liquid (rain, water, etc.).
- Defects due to alteration or deterioration of the product caused by a fall within 3 meters, accidental shock or immersion, voluntary or involuntary.
- Defects due to abnormal use of the product, installation of spare parts not in accordance with instructions in this manual or at www.pnj.fr.
- Damage resulting from a repair performed by the user themselves or an unauthorized third party,

excluding exchange of spare parts provided by PNJ.

- Defects caused by parts not supplied by PNJ, including a battery not approved by PNJ. All products found to be defective after analysis will be returned to the shipper at their expense.

The spare parts necessary for the use of the product are available for 12 months, from the date of first commercialization of the product. Wear parts: Battery: 6 months.

14. RECYCLING



These symbols indicate that this product should not be disposed of with other household waste. Selective collection of electrical and electronic waste: Electrical products should not be disposed of with household products. According to the European Directive 2012/19 / EC for the disposal of electrical and electronic equipment and its execution in national law, used electrical products must be collected separately and arranged at collection points provided for this purpose. Consult local authorities or your dealer for recycling advice.

15. DECLARATION OF CONFORMITY



SAS PNJ, 110, Esplanade du Général de Gaulle 92400 Courbevoie, France, declares under its sole responsibility that the product described in this manual complies with the requirements of the Directives R&TTE 1999/5/CE et RoHS 2011/65/EU.

A copy of the Declaration of conformity is available in the following website:
www.pnj.fr/certifications

A handwritten signature in black ink, appearing to be 'C. Pouthier', written over a horizontal line.

Date: 24/03/2017

Christian Pouthier, product manager SAS PNJ

16. TRADEMARKS

- FR** Les marques citées sont des marques déposées par leur fabricant respectif. Photos et caractéristiques non contractuelles. Garantie: 1 an. Fabriqué en RPC.
- EN** All brands or product names are or may be trademarks of their respective owners. Pictures and specifications are not contractual. 1 year warranted. Made in PRC.
- NL** De vermelde merken zijn gedeponeerde merken door hun respectievelijke producent. Foto's en kenmerken niet contractueel. Geproduceerd in China. Garantie: 1 jaar.

17. MODIFICATIONS

The explanations contained in this User Manual are provided for information purposes only and may be subject to modification, without prior notice. SAS PNJ cannot be held responsible directly or indirectly for any prejudice or loss of data resulting from an error or omission from this document. SAS PNJ reserves the right to modify the product and its operating instructions without any restriction or obligation to inform the user. Thus, the purchased product may differ somewhat from the one described in this document. The latest version of the online User Guide prevails over this one. To obtain it, go to: www.pnj.fr

NOTES

